

CertainTeed

FLINTLASTIC[®] SA

Self-Adhering SBS Modified Bitumen Roof Systems



CertainTeed
SAINT-GOBAIN



After more than a century of making reliable, durable roofing materials, CertainTeed remains a leading trusted brand for roofing distributors and contractors. We're rated #1 with America's building and remodeling professionals.

So whether you have a residential or commercial project, you can turn to CertainTeed with confidence. We've been around a long time, and our expertise goes into giving you better products.

We manufacture complete systems and protect you with strong warranties. We use the highest quality materials, and that makes for better roofs — not to mention lower life-cycle costs. It's all a part of our promise to you.

Quality made certain. Satisfaction guaranteed. TM

**Goes down fast. Stays on strong.
Flintlastic® SA performs in all the right ways.**

What's more important to you? Speed of installation, durability or appearance? The Flintlastic SA (self-adhering) SBS modified bitumen low slope roofing system is a premium performer in all these areas.

What is the SA system?

With high quality materials bottom to top, components of the Flintlastic SA system include:

- Flintlastic® SA NailBase (mechanically attached)
 - Flintlastic® SA PlyBase (self-adhering)
 - Flintlastic® SA MidPly (self-adhering)
 - Flintlastic® SA Cap (self-adhering)
 - Flintlastic® SA Cap FR (fire-rated, self-adhering)
 - Flintlastic® SA Cap CoolStar (self-adhering)
 - Flintlastic® SA Cap FR CoolStar (fire-rated, self-adhering)
 - FlintPrime® SA (quick-dry primer)
- Please see page 12 for product details.

What are the advantages?

No torches, no hot asphalt, no fumes and no mess — all of which means application is much cleaner and faster. Plus, equipment needs are minimal. These advantages are even more amazing considering the long system life you can expect.

Where can I use it?

The value associated with labor savings and safety can be applied to any roof project. In addition, Flintlastic SA roof systems are ideal when access to the roof is limited, such as high-rise buildings. And no asphalt kettle means no odor, which makes SA systems an ideal solution on healthcare, education, hospitality and residences/condos where occupant comfort is tremendously desirable.

Considerations for Intended Use

If multiple SA products are listed, products are listed in order of warranty duration from shortest to longest, with the exception of SA Cap and SA Cap-FR; SA Cap FR is intended for use where Class A fire rating is required (see UL Directory for Class A system specification).

NOTE: Removal of the roof system (at end of life) may be difficult when adhering PlyBase or MidPly direct to a roof deck (i.e. wood, concrete).

Deck	Insulation/Coverboard*	SA Anchor/Base	SA Interply	SA Cap
Steel	Required	NailBase (MF) PlyBase (SA) MidPly (SA)	Optional PlyBase (SA) MidPly (SA)	SA Cap (SA) SA Cap FR (SA)
Wood/LWIC/ Other, i.e. Gypsum, Cementitious Wood Fiber, Wood Planks	Optional Yes	PlyBase, MidPly		
	No	NailBase (MF)		
Structural Wood Fiber, etc				
Concrete	Optional Yes	PlyBase, MidPly		
	No – Requires FlintPrime SA			

*FlintPrime or FlintPrime SA may be recommended, contact CertainTeed Technical Services for more information.

Energy Savings

Flintlastic SA Cap and SA Cap FR are available with highly reflective granules, meeting ENERGY STAR® requirements for cool roofs. Specific product details can be found on product technical data sheets or by viewing www.energystar.gov.

The Flintlastic SA Family of Products

CertainTeed offers two types of primers for use with Flintlastic SA systems. FlintPrime® asphalt primer and FlintPrime® SA quick-dry primer are designed to enhance the adhesion of self-adhesive roofing membranes. Available in 14 oz spray cans, 1-gallon cans, 3.5-gallon buckets, and 5-gallon pails.

FlintBond® SBS Modified Bitumen Adhesive is a premium grade adhesive. With Flintlastic SA membranes, the trowel and caulk grade are used for endlap, sidelap bead and vertical flashing details. Available in caulk, 3 gallon, 5 gallon and 55 gallon drums.



System Warranties at a Glance

SA System with Adhered Base Ply

Warranty Duration	Warranty Fee (100 SQ Min.)	Insulation/Coverboard	Base	Interply	Cap	Re-Cover	Spec*
15 years	\$7.50/SQ	Optional	SA PlyBase			Prior approval required by CertainTeed Technical Department	SA-C-2-S
15 years	\$7.50/SQ	Optional	SA MidPly		SA Cap FR		SA-I-2-S
20 years	\$12.50/SQ	Optional	SA PlyBase	SA PlyBase	SA Cap SA Cap FR		SA-C-3-S SA-I-3-S
20 years	\$12.50/SQ	Optional	SA MidPly		SA Cap SA Cap FR		SA-C-2-S SA-I-2-S
25 years	\$15.00/SQ	Double layer, 2nd layer adhered		SA MidPly	SA Cap SA Cap FR		SA-C-3-S SA-I-3-S

SA System with Mechanically Attached Anchor Sheet

Warranty Duration	Warranty Fee (100 SQ Min.)	Insulation/Coverboard	Base	Interply	Cap	Re-Cover	Spec*
12 years	\$4.00/SQ	Optional	SA NailBase		SA Cap SA Cap FR	Approved	SA-C-2-S SA-IN-2-S SA-N-2-S
15 years	\$7.50/SQ	Optional	SA NailBase	SA PlyBase		Prior approval required by CertainTeed Technical Department	SA-C-3-S
20 years	\$12.50/SQ	Optional	SA NailBase	SA MidPly			SA-IN-3-S SA-N-3-S
20 years	\$12.50/SQ	Optional	SA NailBase	2-SA PlyBase			SA-IN-4-S SA-N-4-S

NOTE: Gold Star contractors have the option to offer their customers a 25% warranty duration extension with the CertainTeed Integrity Maintenance Coverage program. *Refer to CertainTeed Commercial Systems Specifications.

Important Application Considerations

Every professional roofer is familiar with the tools needed to complete a roof installation, but just as a recap, specific tools you'll need to install Flintlastic® SA include:

- A weighted roller for pressing the membrane into place, 2" to 4" in diameter (40-75 lbs.).
- Suitable trowel for applying adhesive to flashing details.
- Roofer's knife with hooked blade.
- Long-handled (standing) roller with 1/8"-1/4" nap for applying primer (1/8" nap for smooth surfaces, 1/4" nap for more porous surfaces).
- Caulk gun for applying beads of FlintBond adhesive.
- Seam probing tool to check for small voids.

Please Keep in Mind:

- Do not attempt application if ice, snow, moisture or dew are present. Ambient temperature must be 50°F or above.
- Substrates must be free of dust, dirt, oil, debris and moisture.
- Store Flintlastic SA rolls indoors on pallets, protected from the elements. Rolls that are improperly stored or have been warehoused for prolonged periods of time may lose their tack and should not be used.

- If the material isn't bonding, STOP the application!
- Always remember to put safety first and follow all OSHA safety guidelines with any roofing installation.
- Primer, if used, must be applied at the specified rate and must be allowed to thoroughly dry.
- Work with manageable lengths of MidPly and Cap for the particular job. Where appropriate, cut rolls into 1/3- or 1/2-roll lengths and allow material to relax prior to installation.
- In cooler weather, a hand-held hot air welding gun such as the Leister Triac™ (110 volt power required) or Primus Sievert PNS-4 Hot Air Kit, can be used to warm the sidelap areas and improve adhesion (prior to application of the FlintBond SBS Modified Bitumen Adhesive).
- Target 1/4" FlintBond bleed out at endlap areas. Use caution not to roll weighted roller into bleed out."
- **All plies of the assembly should be installed in one day. If blue film must be exposed for longer periods of time, cover with tarp or suitable alternate protection.**
- When applying MidPly (or PlyBase) directly to substrate, design adequate roof ventilation into the system through the use of roof relief vents.

- Do not mix Flintlastic® SA membranes with other types of roof membranes. Flintlastic SA membranes are specifically designed to be applied together. The permanent top film of the MidPly, PlyBase and NailBase cannot receive torching, hot asphalt or other non self-adhering application methods. The Flintlastic SA Cap (or SA Cap FR), PlyBase and MidPly cannot be applied to any surfaces other than as described herein.
- Do not use cold adhesives with Flintlastic SA membranes other than for flashing details and cap sheet overlaps as described herein.
- Refer to the CertainTeed Commercial Roof Systems Manual for complete requirements.
- When applying Flintlastic SA on slopes exceeding 1" in 12", membranes shall be back nailed. When applied parallel to the slope, Flintlastic SA shall be blind-nailed at end laps 2" in from top edge, 6" o.c. through tin discs and to wood nailers. See General Requirements Section of the CertainTeed Commercial Roof Systems Specifications for details.

Application of Base Sheet

Flintlastic SA NailBase may be used as an anchor sheet (mechanically fastened); PlyBase or MidPly may be used as a base ply (fully adhered). Beginning at the low point of the roof, mechanically fasten Flintlastic SA NailBase to nailable deck using appropriate fasteners (**see fasteners chart**). Start with an appropriate roll width (1/3 or 1/2 roll) to accommodate offsetting of sidelaps of subsequent layers of MidPly and/or Cap sheet. Install so that no sidelaps are against the flow of water. A minimum fastening pattern is every 9" on center on sidelaps and every 18" on center in two staggered rows in the field of the sheet.

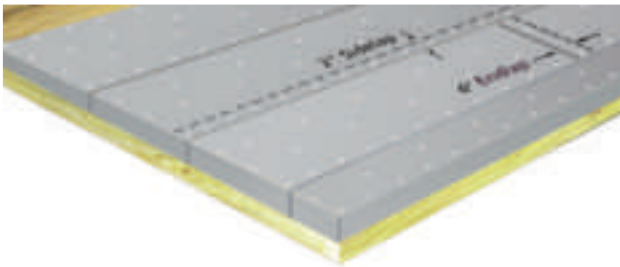

Overlap base sheet sidelaps 2" and endlaps 4".

Offset endlaps a minimum of 3'. Turn base sheet over facia by 2" and fasten. **Do Not Leave Base Sheet Exposed To The Weather.** Cover in the same day with optional SA interply and SA Cap/SA Cap FR.



SA PlyBase/MidPly may be adhered to mechanically fastened or adhered FlintBoard® ISO/FlintBoard ISO Cold, or direct to primed substrates (i.e. concrete roof decks, gypsum coverboards, etc).

Standard (Round Head) Roofing Nails and Cap
(Note: CertainTeed does not permit the use of plastic caps) For use with Base Sheet, Flash/Termination Bar on Plywood Decks, Non Veneer Decks, Wood Plank Decks



Large Head Roofing Nails For use with Base Sheet, Flash/Termination Bar on Plywood Decks, Non Veneer Decks, Wood Plank Decks



Base Sheet Fasteners for some Cementitious Roof Decks For use with Base Sheet on Light Weight Insulation Concrete, Poured Gypsum



Self-Locking Fasteners For use with Base Sheet on Cement/Wood Fiber



Insulation Fasteners

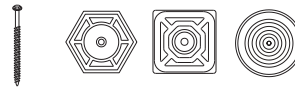

When using FlintPrime® SA, allow to dry thoroughly, but no more than four hours to retain tack-enhancing properties. It is recommended to prime fasteners with FlintPrime Aerosol before installing the base ply. Before adhering a base ply, sweep the surface of the deck or insulation to remove any debris that could interfere with adhesion.

Start application at the low point of the roof. Install flush to roof edge. Design layout so that no sidelaps are against the flow of water.

Cut rolls into manageable lengths. Fold the membrane back halfway lengthwise to remove the split release film.



Press membrane securely into place and repeat with the opposite half of the membrane. Use a heavy, weighted roller over the entire surface of the PlyBase or MidPly to secure the membrane. Work outwards to eliminate voids.

Overlap sidelaps of subsequent PlyBase or MidPly membrane lengths 2" and endlaps 4". Offset (stagger) endlaps minimum 3'. Cut endlaps at opposing diagonal corners at an angle approximately 5-1/2" long by the selvage dimension from the corners to minimize "T"-seams. Apply a bead or small trowel dab (quarter size) of FlintBond® SBS Modified Bitumen Adhesive, trowel or caulk grade, at the edge of the angled cut to avoid a capillary. Use of a hand-held hot air gun at the joint area prior to rolling the membrane will maximize adhesion. In areas prone to cold temperatures, snow and freeze-thaw cycles, it may be more effective to use the hot air gun to form joints, and to completely fill all mole holes with asphalt that has been slightly melted using the gun. It is recommended to apply a bead of FlintBond SBS Modified Bitumen Adhesive, caulk grade, at all MidPly (or PlyBase) side and endlaps to eliminate a capillary.

Do Not Leave Base Sheet Exposed To The Weather.
Cover in the same day with optional SA Interply and SA Cap/SA Cap FR.

Refer to CertainTeed Commercial Systems Specifications for comprehensive construction details.

Application of Interply (optional)

Note: Proceed to "Before Installing Flintlastic® SA Cap (or SA Cap FR)" if installing a 2-ply system.

Before installing Flintlastic SA PlyBase or MidPly sweep the underlying anchor sheet or base ply to remove any debris that could interfere with adhesion. Start with PlyBase or MidPly at the low point of the roof with appropriate roll width to offset sidelaps 18" from sidelaps of anchor sheet or base ply. all flush to roof edge. Design layout so that no sidelaps are against the flow of water.

Cut rolls into manageable lengths. Fold the membrane back halfway lengthwise to remove the split release film. Press membrane securely into place and repeat with the opposite half of the membrane. Use a heavy, weighted roller over the entire surface of the PlyBase or MidPly to secure the membrane. Work outwards to eliminate voids.

Overlap sidelaps of subsequent PlyBase or MidPly membrane lengths 2" and endlaps 4". Offset (stagger) endlaps minimum 3'.

Cut endlaps at opposing diagonal corners at an angle approximately 5-1/2" long by the selvage dimension from the corners to minimize "T"-seams. Apply a bead or small trowel dab (quarter size) of FlintBond SBS Modified Bitumen Adhesive, trowel or caulk grade, at the edge of the angled cut to avoid a capillary. Use of a hand-held hot air gun at the joint area prior to rolling the membrane will maximize adhesion. In areas prone to

cold temperatures, snow and freeze-thaw cycles, it may be more effective to use the hot air gun to form joints, and to completely fill all mole holes with asphalt that has been slightly melted using the gun. It is recommended to apply a bead of FlintBond SBS Modified Bitumen Adhesive, caulk grade, at all MidPly (or PlyBase) side and endlaps to eliminate a capillary.

Do Not Leave Base Sheet Exposed To The Weather.
Cover in the same day with optional SA Interply and SA Cap/SA Cap FR.

Refer to CertainTeed Commercial Systems Specifications for comprehensive construction details.

Before Installing Flintlastic SA Cap or SA Cap FR

If roof edge detail utilizes edge metal, proceed as follows. If MidPly or (PlyBase) has been applied, install minimum

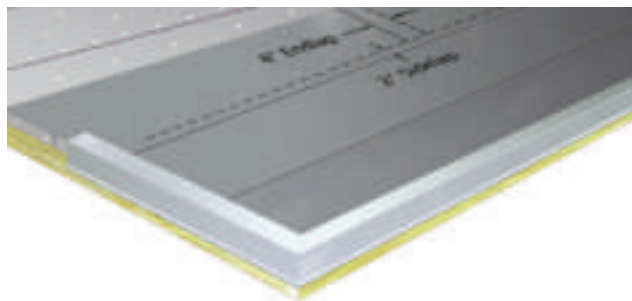

26 gauge edge metal using appropriate fasteners, and set entirely in a uniform 1/8"-1/4" thick troweling of FlintBond SBS Modified Bitumen Adhesive, trowel grade. Remove any oil from the metal surface using a vinegar and water solution. Prime the horizontal surface of the metal with FlintPrime SA and allow primer to dry. Apply a bead of caulk grade FlintBond adhesive to the edge of the metal where it meets the MidPly (or PlyBase). Proceed with Flintlastic SA Cap (or SA Cap FR) installation.

If an interply is not specified, install a 9" wide flashing strip of PlyBase or MidPly (material assumed to match base ply) "onto the field of the roof and flush to the roof edge, self-adhered. Install minimum 26 gauge edge metal using appropriate fasteners, set entirely in a uniform 1/8"-1/4" thick troweling of FlintBond SBS Modified Bitumen Adhesive, trowel grade.

Remove any oil from the metal surface using a vinegar and water solution. Prime the horizontal surface of the metal with FlintPrime® SA and allow primer to dry. Apply a bead of caulk grade FlintBond at the roof side edge of the metal where it meets the flashing strip.

Similarly, complete your sheet metal flashing installation using cut PlyBase or MidPly flashing collars at all flashing details prior to flashing application. Seal edges of PlyBase or MidPly flashing collars with a bead of FlintBond. See "Typical Construction Details" pages for examples.

If an interply is specified, set flanges in trowel grade FlintBond and properly fasten. If an interply is not

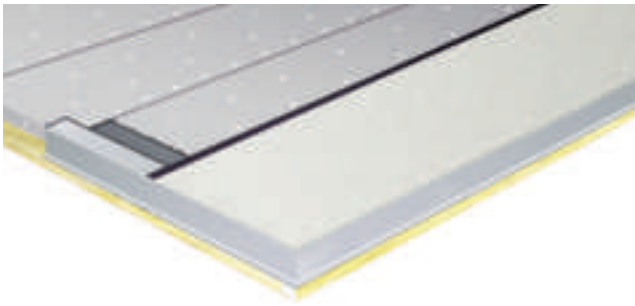

specified, complete sheet metal flashing installation using cut PlyBase or MidPly flashing collars at all flashing details. All cap sheet flashings installed to transitions that overlap onto mineral surface must be set in a uniform troweling of FlintBond® trowel grade adhesive.

Application of Flintlastic SA Cap (or SA Cap FR)

Before installing Flintlastic® SA Cap or SA Cap FR, sweep the underlying anchor sheet or base ply to remove any debris that could interfere with adhesion. To install Flintlastic SA Cap (or SA Cap FR), start at the low point of the roof with an appropriate roll width to offset sidelaps from the underlying membrane a minimum of 18". Work with manageable lengths for proper handling.



Position SA Cap (or SA Cap FR) with selvage edge release strip at high side of roof. Install in weather-lapped fashion, with no laps against the flow of water.

Once positioned, lift and fold back (lengthwise) the lower half of the membrane. Remove the split release film and press firmly into place. Then repeat with the other (high side of the roof) half of the membrane.



Follow the same layout and split release film procedures as for MidPly (or PlyBase), but overlap sidelaps 3" and endlaps 6". Use a weighted roller over the entire surface of Flintlastic SA Cap (or SA Cap FR) to secure it in place and prevent voids, working outward from the center of the sheet.

As subsequent membrane lengths are installed, remove the selvage edge release strip just prior to overlapping to keep the adhesive area protected and clean.



Cut endlaps at opposing diagonal corners at an angle approx. 3" by 5-1/2" from the corners to minimize T-seams.

FlintBond trowel grade is required on the entire 6" width of each endlap prior to overlapping.

Apply a uniform 1/8"-1/4" troweling of the FlintBond on the entire width of the endlaps to the underlying membrane. Install the overlapping sheet. Always apply FlintBond (extend beyond underlying lap minimum 1/4") on the entire width of any overlap when applying SA Cap (or SA Cap FR) over another mineral surface such as the SA Cap (or SA Cap FR) endlap.

At all vertical and other flashing points, apply FlintBond trowel grade wherever there is an overlap onto mineral surfacing.

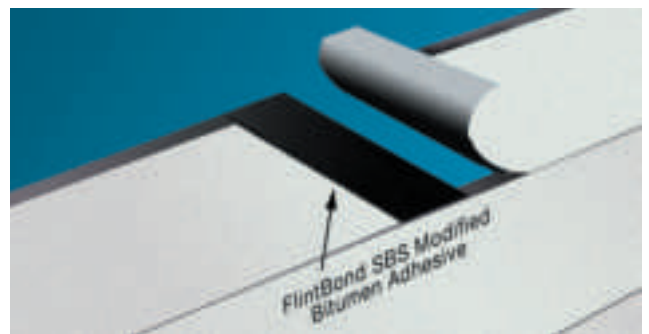

Once the membrane has had a chance to bond, check all laps and joints for full adhesion. If the membrane can be lifted at any area it is not properly adhered. A seam probing tool can be helpful to check for small voids at laps. If necessary, use appropriate hand-held hot air welding tool and seam roller or an application of FlintBond to seal small unbonded areas if they exist.

Construction Details

Included in this manual are a few common construction details. Please refer to CertainTeed's standard details or the NRCA for details not found within this manual. Important to note with all details, all metal must be primed and set in FlintBond® trowel grade adhesive and all overlaps over mineral surfacing must utilize FlintBond trowel grade adhesive.

The Proper T-Seam Detail

- Before adhering Flintlastic® SA PlyBase or MidPly, Cap (or SA Cap FR) endlaps, trim the underlying sheet's lower corner at the end of the roll.

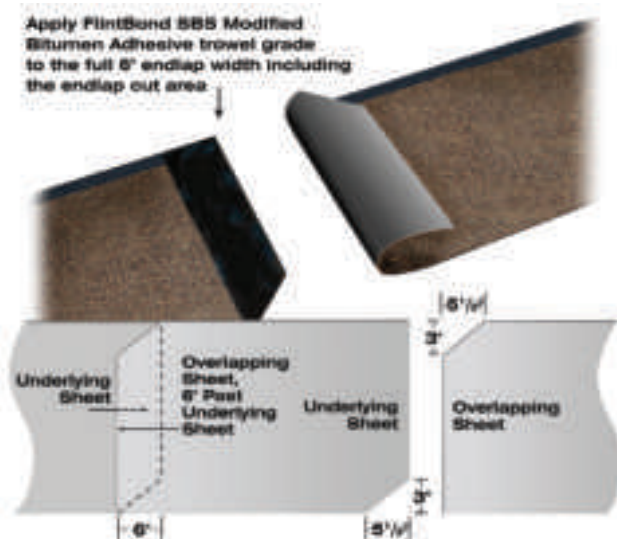

- Follow with the overlapping sheet, trimming the upper outside corner.
- Corners should be trimmed on a diagonal angle 5-1/2" long from end of roll to outside edge.
- Width of trim should be equal in width to the sidelap specified (3" for Flintlastic SA Cap [or SA Cap FR] and 2" for Flintlastic SA MidPly [or PlyBase]).
- Trimmed corners should be completely covered by application of succeeding courses.
- Note: If using Flintlastic SA PlyBase or MidPly, apply quarter-size dab of FlintBond at T-seam area. If using Flintlastic SA Cap (or SA Cap FR), the endlap should be completely set in trowel grade FlintBond along the entire 6" lap width.

Rake Edge Detail

- Cut selvage area at an angle at all rake edges.
- Apply a bead of FlintBond caulk along cut edge to eliminate mole holes.

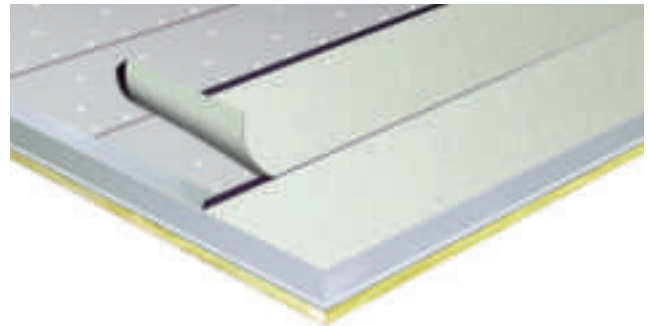

Typical Construction Details – Flintlastic® SA 2-Ply System

Vent Pipe Collar Detail

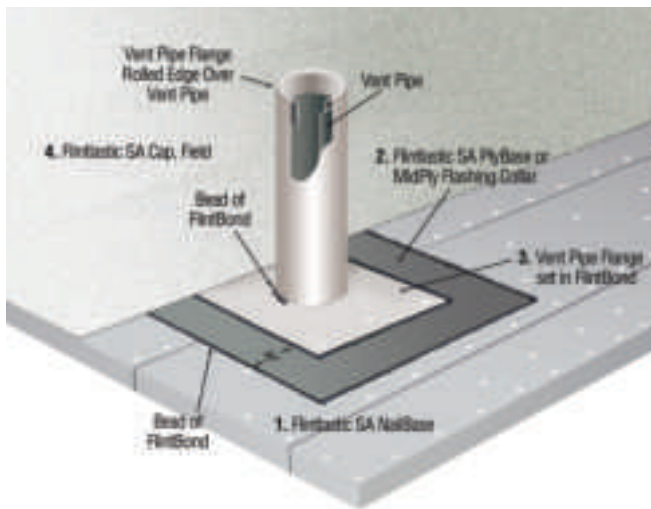

Drain Detail

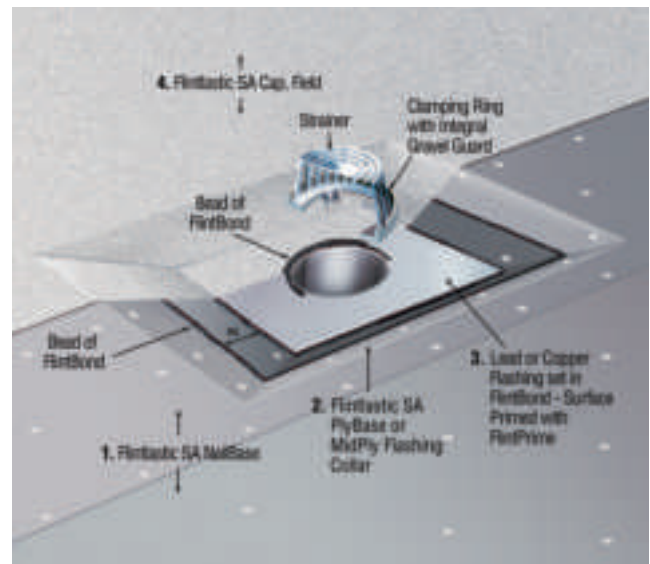

Inside Corner

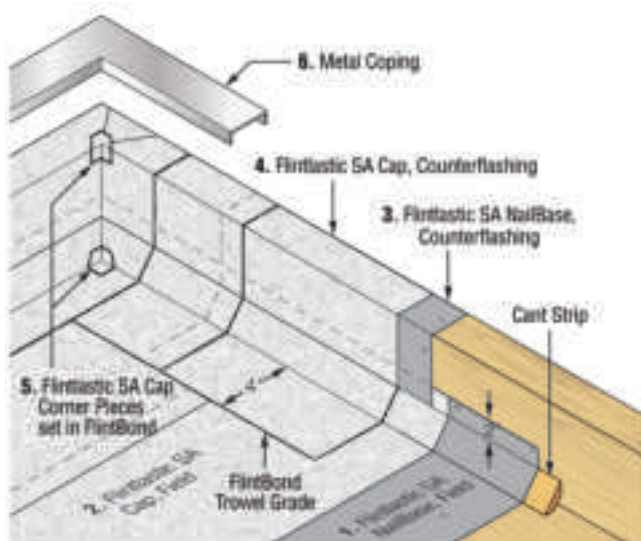

Outside Corner

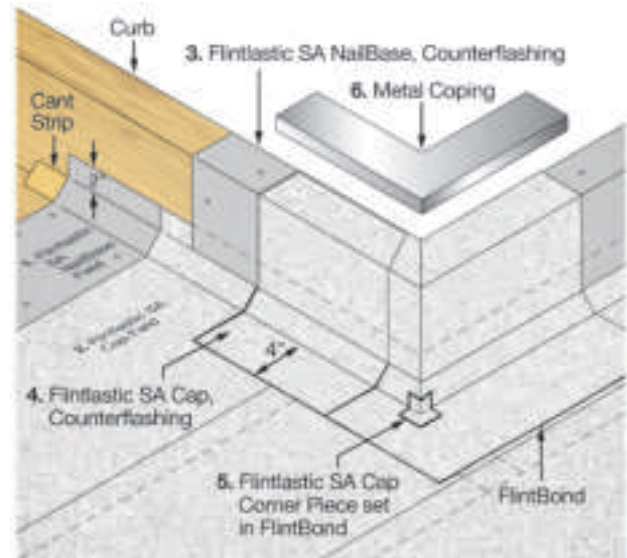

Typical Construction Details – Flintlastic® SA 2-Ply System

Wood Parapet Wall Detail

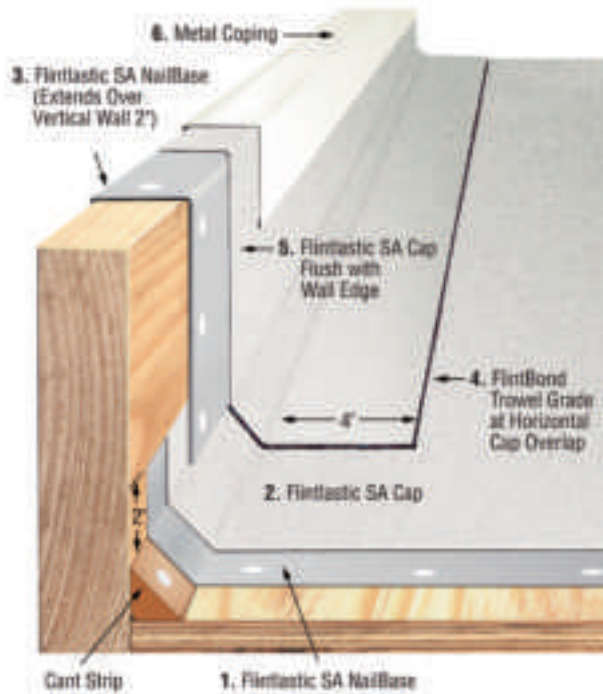

Concrete Wall Termination with Surface Mount Flashing

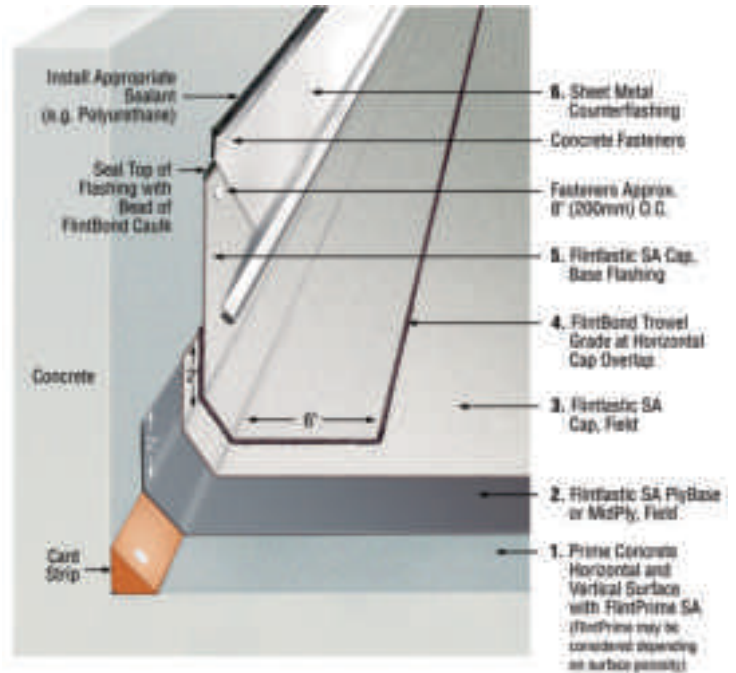

Scupper Detail

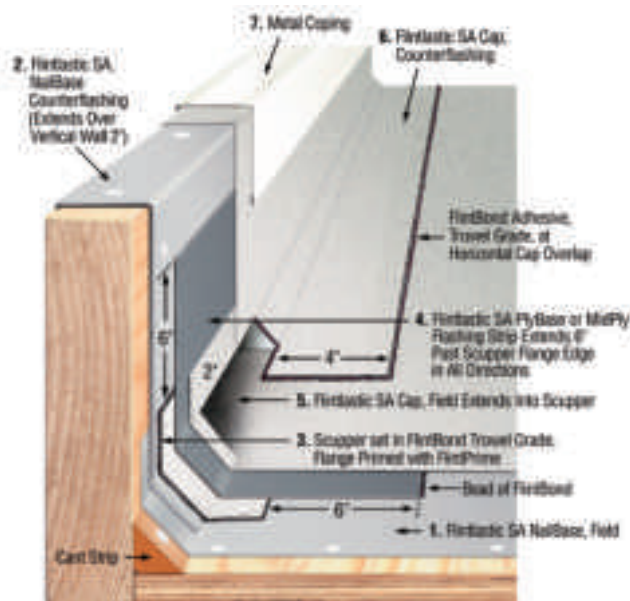

Edge Detail with Insulation

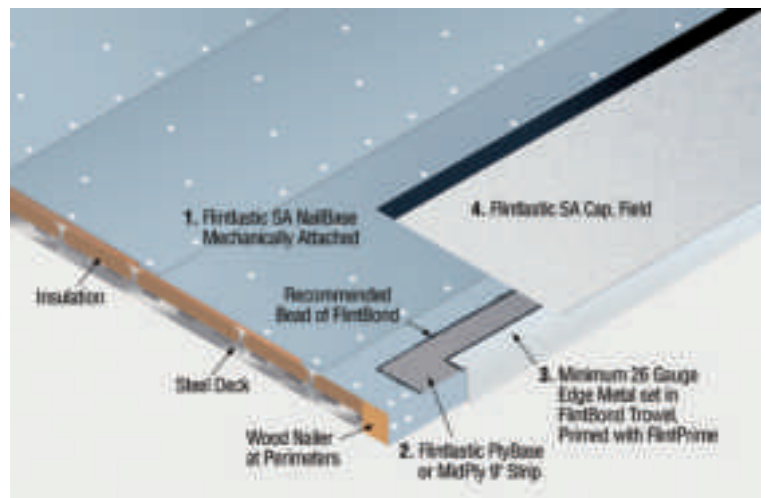

2-Ply System Specifications

SPECIFICATION: SA-N-2-S

Flintlastic® SA NailBase, nailed.
 Flintlastic SA Cap (FR), self-adhered.
For use over nailable decks

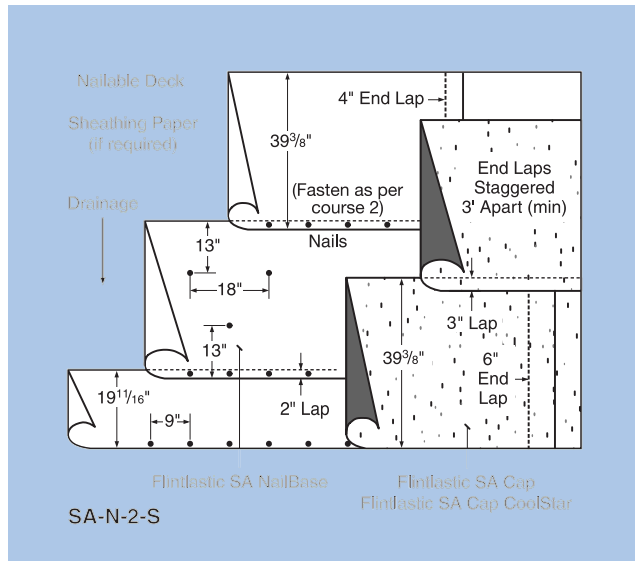

Note: Flintlastic SA MidPly, FlintBond Trowel Grade and FlintBond Caulk Grade are needed for flashing details and mineral surface membrane overlaps. FlintPrime (SA) is needed for surfaces that require priming.

Cants

In angles of roof deck and vertical surfaces, the roofing contractor shall furnish and install an approved cant strip with a minimum 3" face.

SPECIFICATION: SA-C-2-S

Flintlastic SA NailBase, applied using hot asphalt, or
 Flintlastic SA PlyBase or MidPly, self-adhered as base ply.
 Flintlastic SA Cap (FR), self-adhered.

**For use over non-nailable decks or
 approved insulation**
 (Flintlastic SA Base required over insulation)

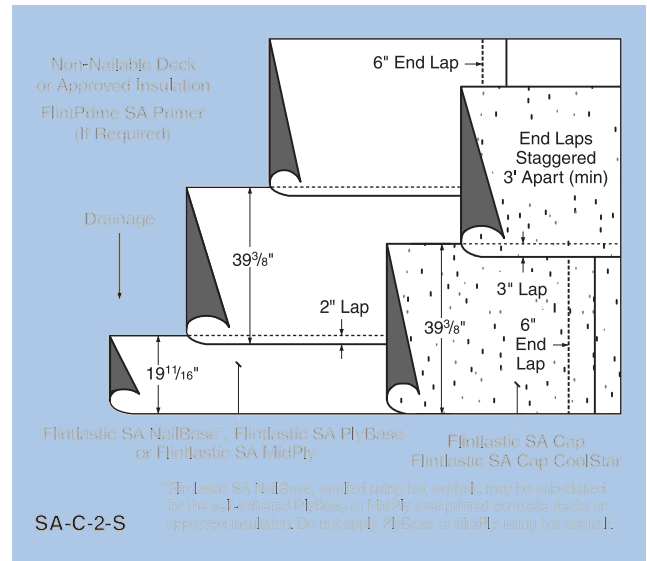

Note: Flintlastic SA MidPly, FlintBond Trowel Grade and FlintBond Caulk Grade are needed for flashing details and mineral surface membrane overlaps. FlintPrime (SA) is needed for surfaces that require priming.

Cants

In angles of roof deck and vertical surfaces, the roofing contractor shall furnish and install an approved cant strip with a minimum 3" face.

Roof System Ventilation

Roof system as shown requires ventilation as per NRCA recommendations.

Typical Construction Details – Flintlastic® SA 3-Ply System

Vent Pipe Collar Detail

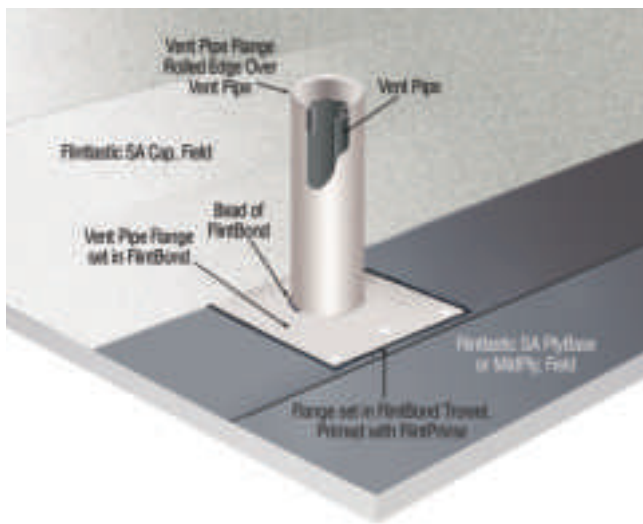

Drain Detail

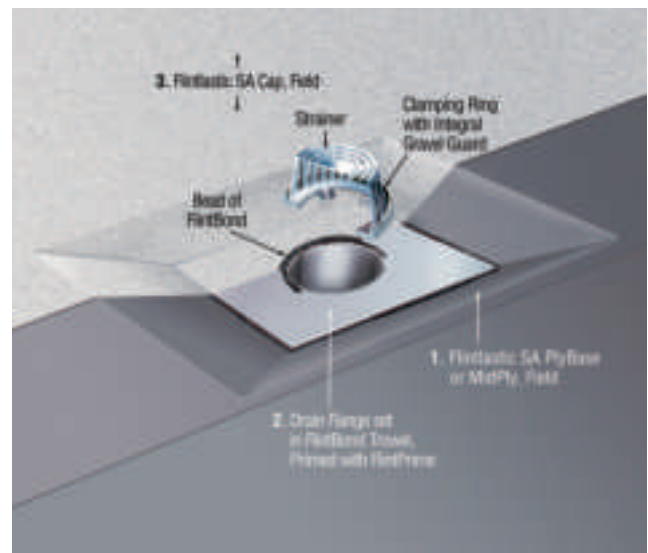

Edge Detail

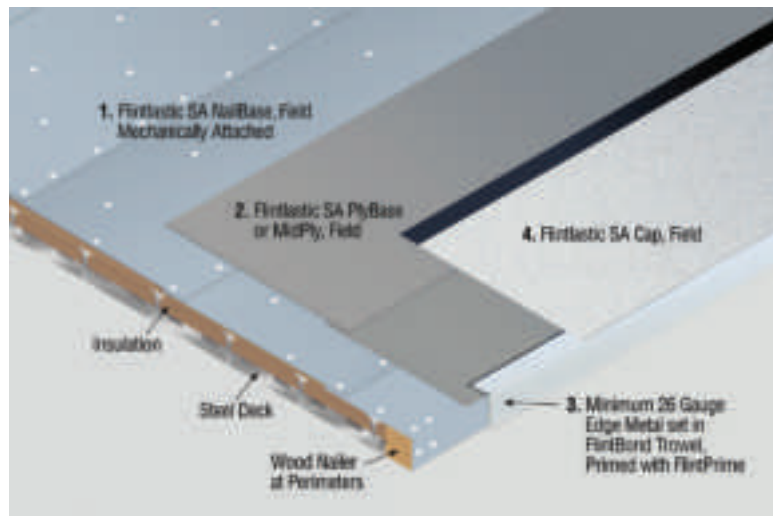

3-Ply System Specifications

SPECIFICATION: SA-N-3-S

Flintlastic® SA NailBase, nailed.

Flintlastic SA PlyBase or MidPly, self-adhered.

Flintlastic SA Cap (FR), self-adhered.

For use over nailable decks

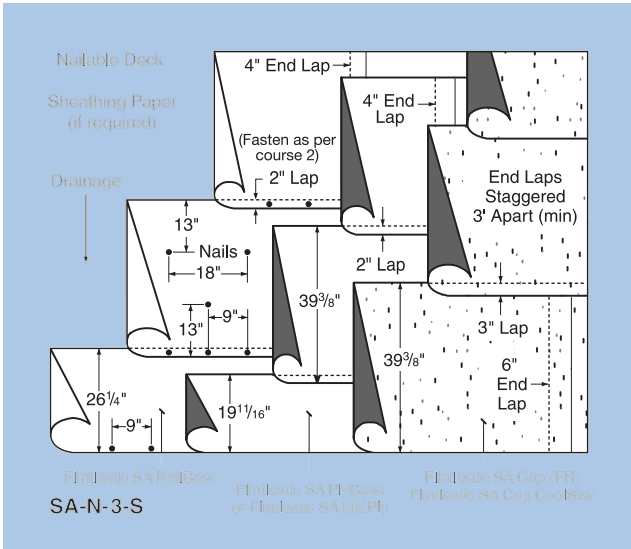

Note: Flintlastic SA MidPly, FlintBond Trowel Grade and FlintBond Caulk Grade are needed for flashing details and mineral surface membrane overlaps. FlintPrime (SA) is needed for surfaces that require priming.

Cants

In angles of roof deck and vertical surfaces, the roofing contractor shall furnish and install an approved cant strip with a minimum 3" face.

SPECIFICATION: SA-C-3-S

Flintlastic SA NailBase, applied using hot asphalt, or

Flintlastic SA PlyBase or MidPly, self-adhered as base ply.

Flintlastic SA PlyBase or MidPly, self-adhered.

Flintlastic SA Cap (FR), self-adhered.

For use over non-nailable decks or approved insulation

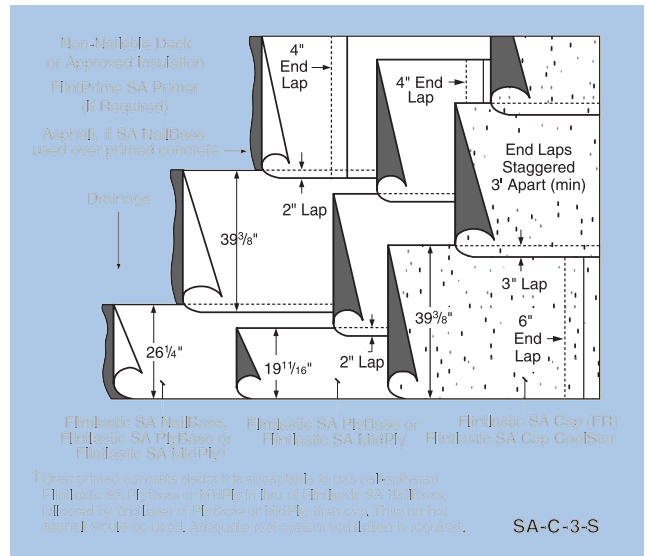

Note: Flintlastic SA MidPly, FlintBond Trowel Grade and FlintBond Caulk Grade are needed for flashing details and mineral surface membrane overlaps. FlintPrime (SA) is needed for surfaces that require priming.

Cants

In angles of roof deck and vertical surfaces, the roofing contractor shall furnish and install an approved cant strip with a minimum 3" face.

	Flintlastic® SA NailBase	Flintlastic® SA PlyBase	Flintlastic® SA MidPly	Flintlastic® SA Cap	Flintlastic® SA Cap FR
Roll Dimensions	64'6" x 39-3/8"	64'6" x 39-3/8"	32'1" x 39-3/8"	32'11" x 39-3/8"	32'11" x 39-3/8"
Thickness	1.5 mm	1.5 mm	2.8 mm	4.0 mm	3.2 mm
Weight	82 lbs	86 lbs	63 lbs	95 lbs	88 lbs.
Coverage	2 Squares	2 Squares	1 Square	1 Square	1 Square
Top Surface	Permanent Film	Permanent Film	Permanent Film	Mineral	Mineral
Bottom Surface	Sand	Removable Release Film	Removable Release Film	Removable Release Film	Removable Release Film
Reinforcement	Fiberglass Mat	Fiberglass Mat	Fiberglass Mat	Non-Woven Polyester Mat	Heavy Duty Fiberglass Mat
Tensile (lb/in)	65/40 (MD/CD)	65/40 (MD/CD)	75/50 (MD/CD)	85/67 (MD/CD)	64/58 (MD/CD)
Elongation (%) (at peak load)	6/5 (MD/CD)	6/5 (MD/CD)	5/5 (MD/CD)	61/66 (MD/CD)	4/4 (MD/CD)
Packaging	Palletized, Bands 20 Rolls Per Pallet	Individual Cartons 20 Rolls Per Pallet	Individual Cartons 20 Rolls Per Pallet	Individual Cartons 20 Rolls Per Pallet	Individual Cartons, 20 Rolls Per Pallet

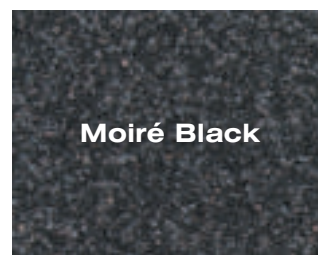
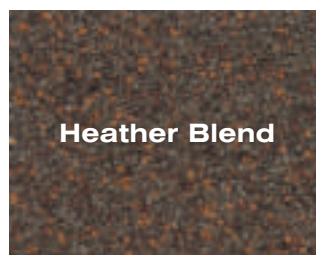
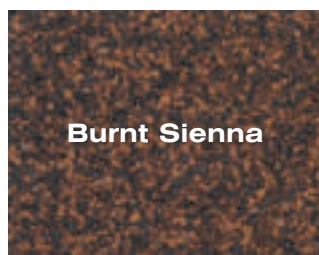

CertainTeed Full Systems



BUR (Built-Up Roofing)



APP Modified Bitumen



SBS Modified Bitumen



Self-Adhering SBS Modified Bitumen



Primer



Adhesive



Coating



Repair



Fasteners

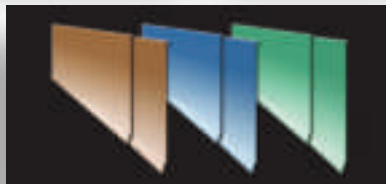

FlintEDGE™



Insulation

For more information on CertainTeed Commercial Roofing Products, go to www.certainteed.com.

Caution: CertainTeed Flintlastic roofing products are intended for use by professional roofing contractors only. It is the responsibility of the installer to follow all appropriate and required safety precautions in conjunction with the installation of any CertainTeed roofing product.

Meets or exceeds ASTM D6164 (SA Mid Ply and SA Cap), ASTM D6163 (SA Cap FR) and ASTM D4601 (SA NailBase and PlyBase).



UL 2218 Class 4 Impact Resistance – Certain systems are UL classified as to impact resistance as described in the UL Roofing Materials and Systems Directory.



ICC-ES ESR-1388

ASK ABOUT ALL OF OUR OTHER CERTAINTEED® PRODUCTS AND SYSTEMS:

ROOFING • SIDING • TRIM • DECKING • RAILING • FENCE
GYPSUM • CEILINGS • INSULATION

www.certainteed.com <http://blog.certainteed.com>

CertainTeed Corporation
20 Moores Road
Malvern, PA 19355

Professional: 800-233-8990
Consumer: 800-782-8777

© 2016 CertainTeed Corporation, Printed in U.S.A.
Code No. COMM-123